

WILD HORSES **FOUR WHEEL DRIVE**

Phone (209) 400-7200 Fax (209) 943-7923 www.wildhorses4x4.com

STAINLESS STEEL EFI THROTTLE CABLE #8265

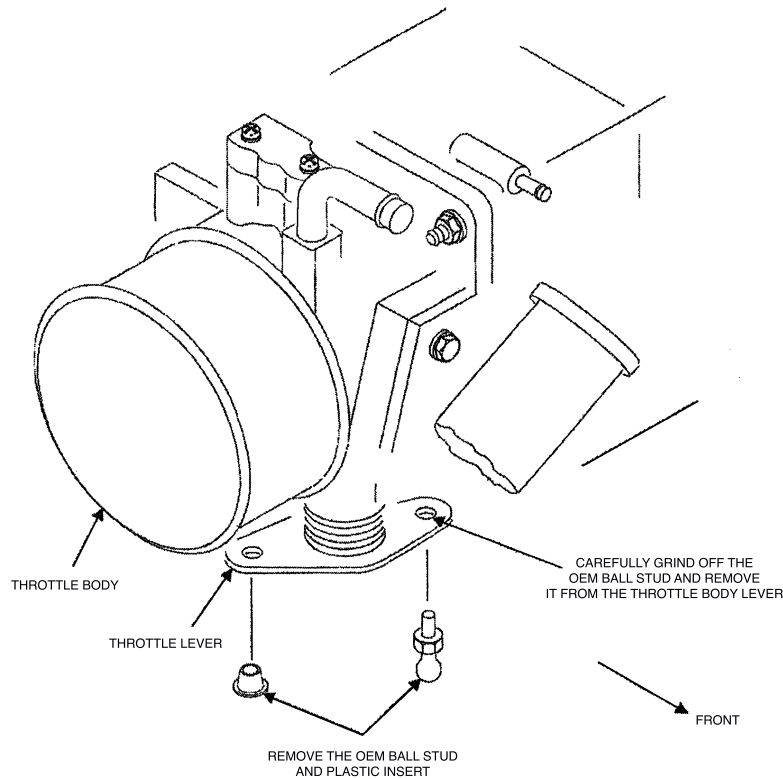

Step 1: Remove the OEM ball stud and plastic insert

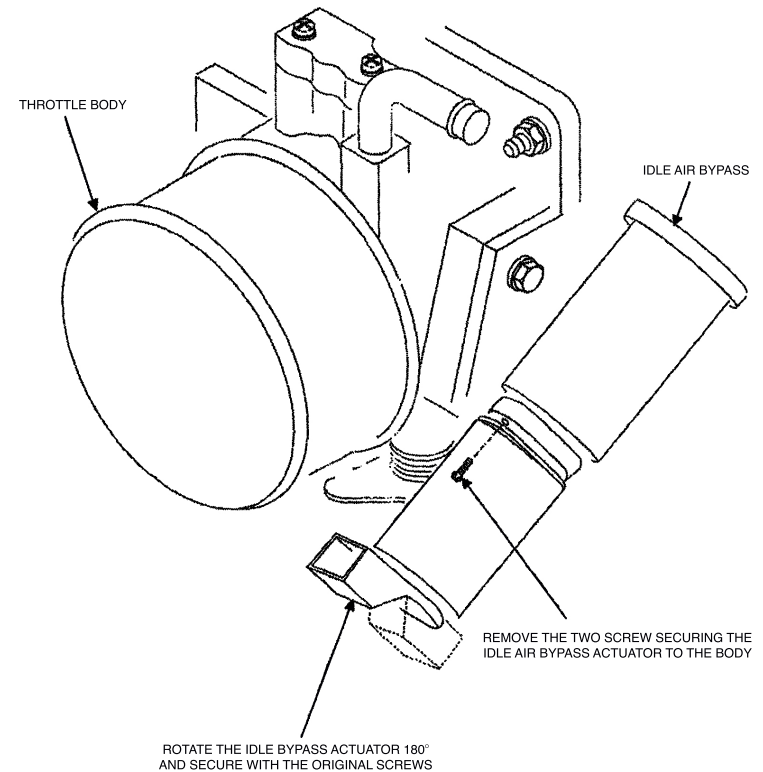

Step 2: Rotate the Idle Bypass actuator 180° so connector is up as shown

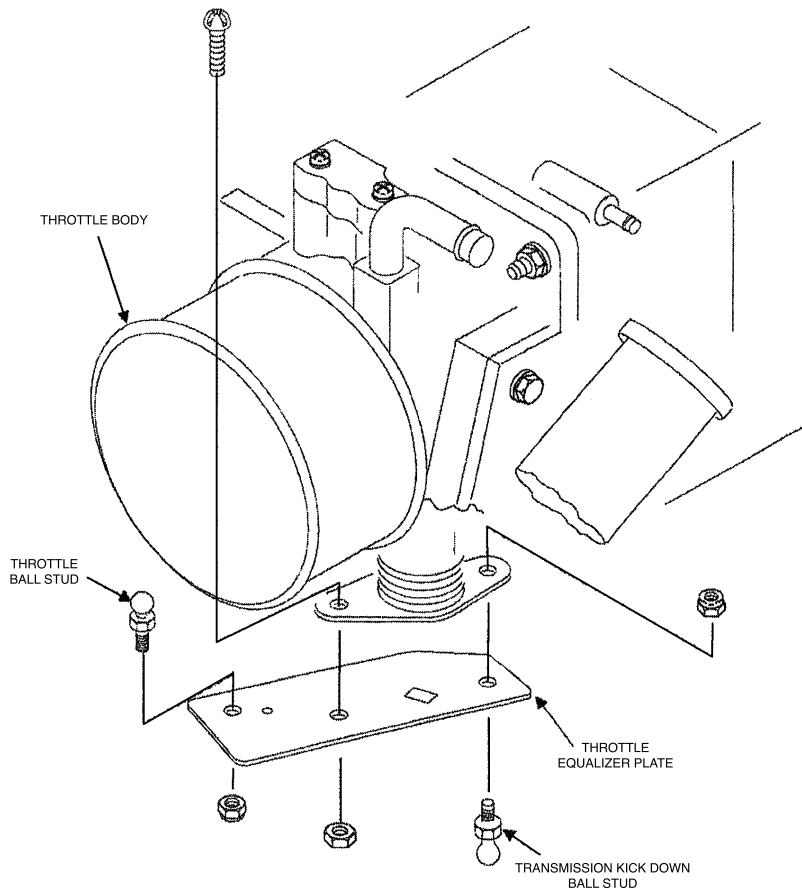

Mount the throttle equalizer and ball studs as shown

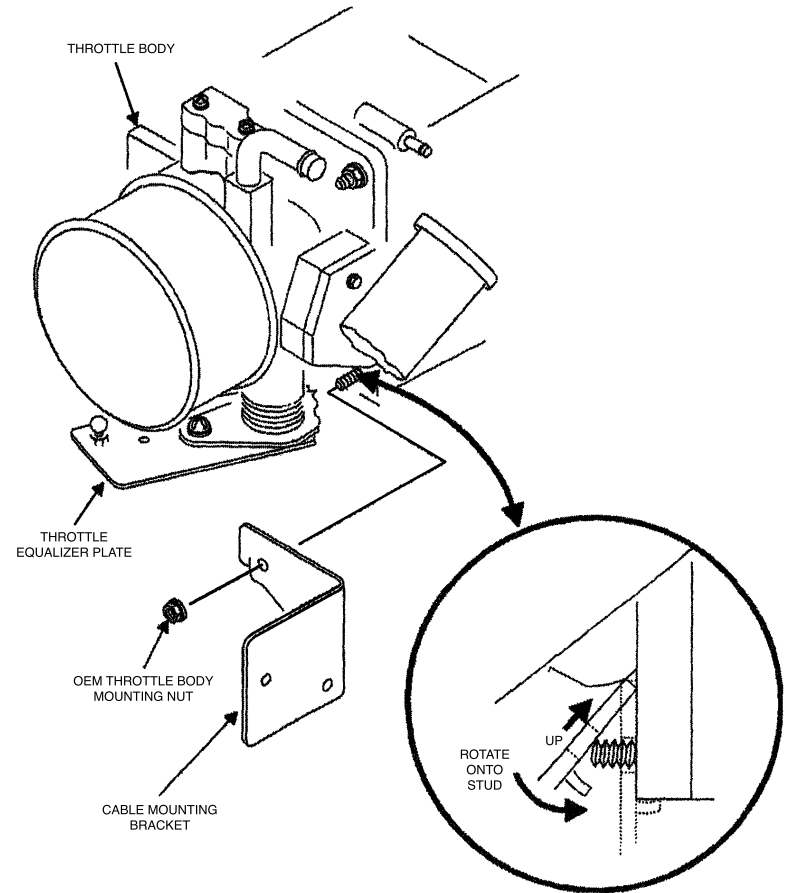

Mount the cable-mounting bracket.

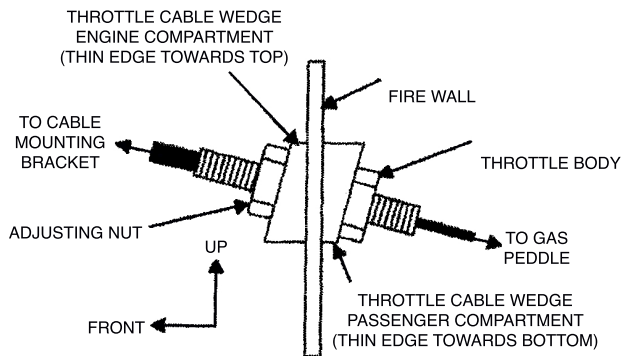
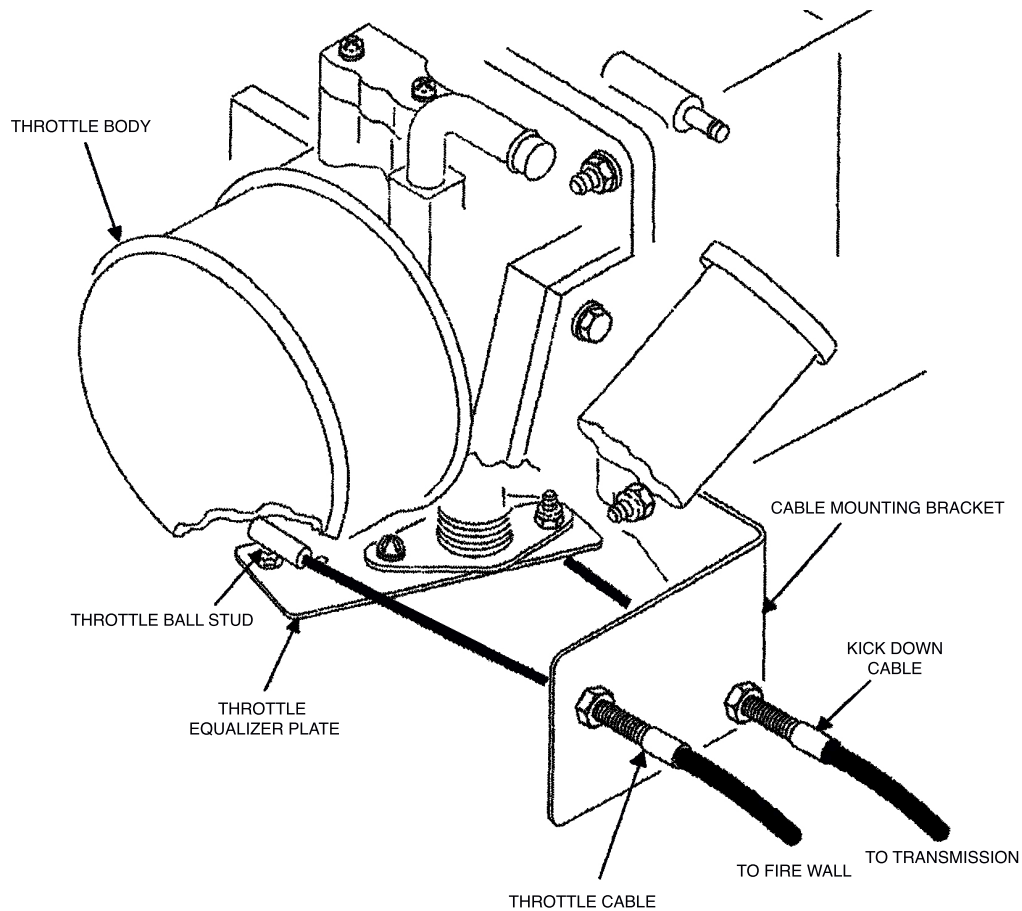

NOTE:
 THE MOUNTING STUDS FOR THE ORIGINAL THROTTLE ROD BELLOWS MAY INTERFERE WITH MOUNTING THE THROTTLE CABLE WEDGES. REMOVE THE STUDS OR GRIND NECESSARY CLEARANCE ON THE THROTTLE CABLE WEDGES

Step 4: Mount the Throttle and Transmission Kick down cable and adjust as required